

INSTALLATION MANUAL

65662AT

LED
BUILT IN



ADJUSTABLE

90
CRI

CE

EAC

UK
CA

RoHS
COMPLIANT



one
LIGHT

230V | COB LED | 15W | IP20 | Adjustable beam | Aluminium

Complete with 350mA driver.

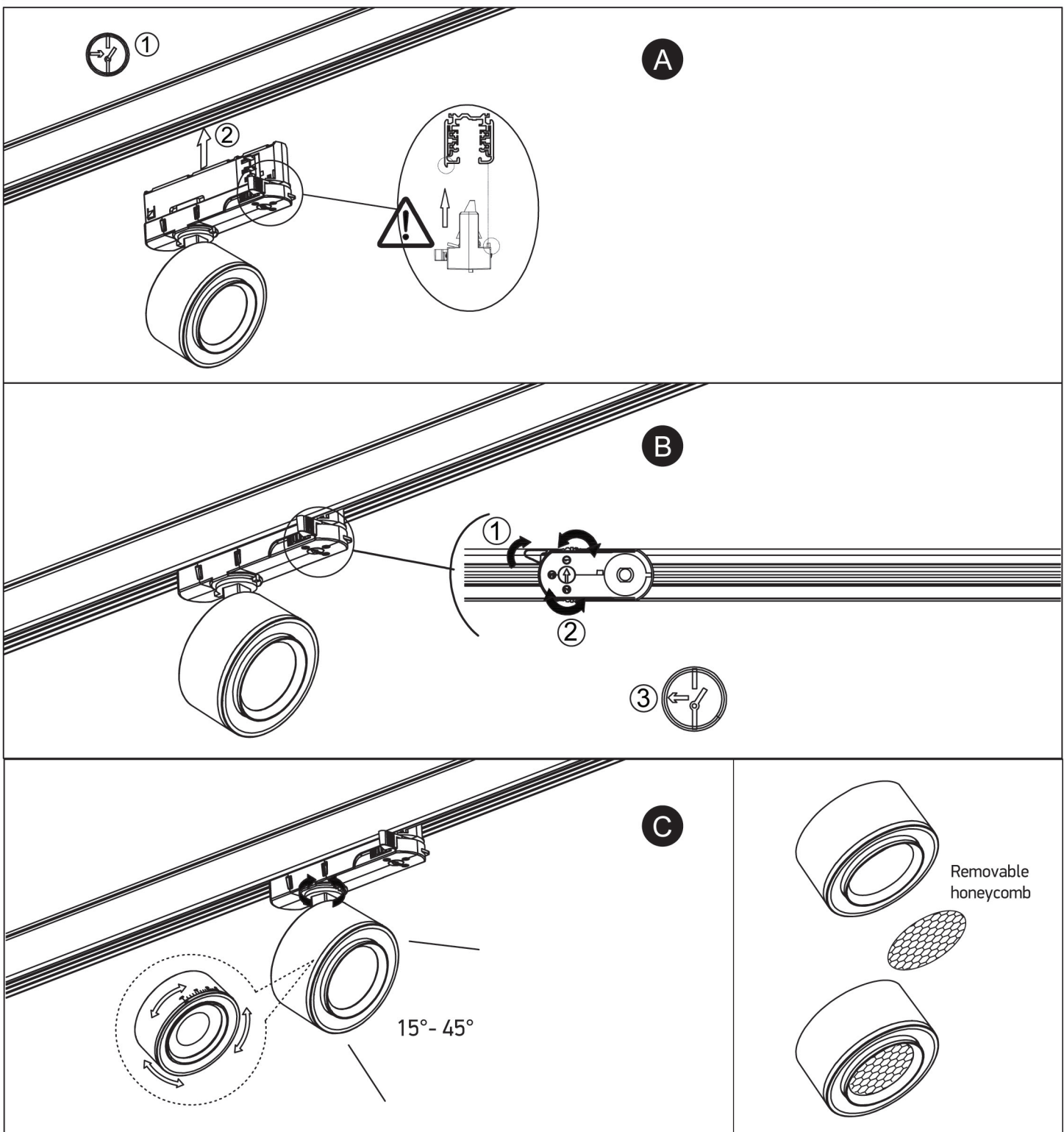
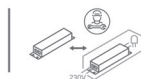

Warnings:

1. Make sure that the product is installed properly before connecting to electricity.
2. Do not cover the fitting.
3. Maintenance and installation should only be carried out by a professional electrician.

INSTALLATION MANUAL

65662BT

LED
BUILT IN



ADJUSTABLE

90
CRI

CE ENEC UK CA

RoHS
COMPLIANT



NOT
DIMMABLE

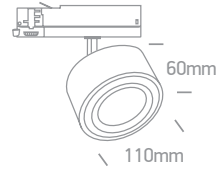

one
LIGHT

230V | COB LED | 25W | IP20 | Adjustable beam | Aluminium

Complete with 600mA driver.

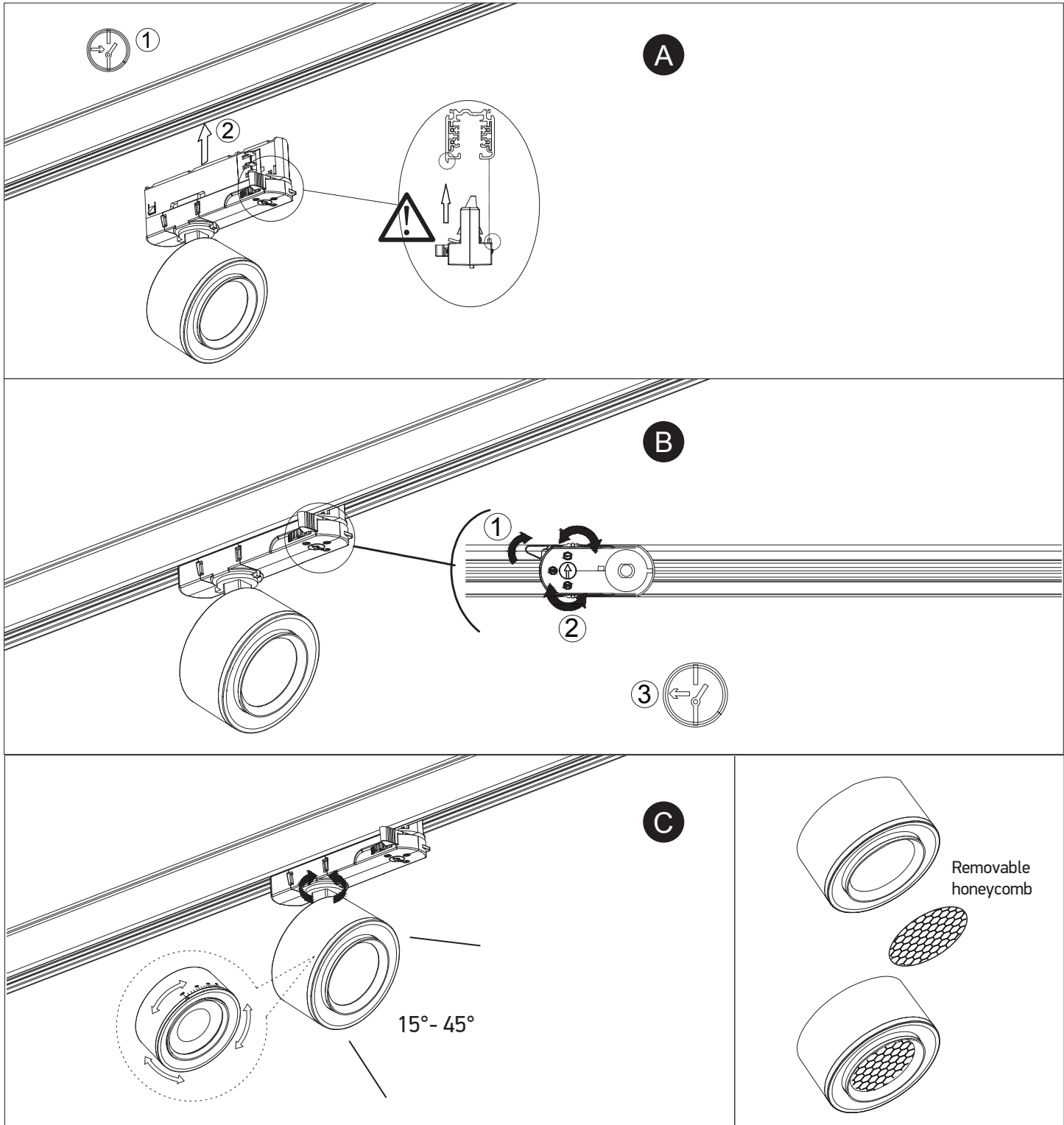
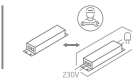

Warnings:

1. Make sure that the product is installed properly before connecting to electricity.
2. Do not cover the fitting.
3. Maintenance and installation should only be carried out by a professional electrician.